

Authority22 Lane Machine Heavy Duty Casters

1. Enlarge hole with 1/2" drill. Refer to *Figure 1*.
2. The 5/16" bolts attaching the angle bracket may have loosened, allowing the holes to wear and the bracket to twist. If so, remove the 5/16" hardware, square the bracket to the side frame and enlarge the holes with a 3/8" drill. Refer to *Figure 1*. Reattach the angle bracket using the included 3/8" flanged bolts & nuts.
3. The new caster bracket is 1/4" (6 mm) taller than the original. Do not use flat washers as spacers. Mount the new caster bracket directly against the bottom of the angle bracket for best support. Refer to *Figure 1*.
4. Place flat washer and both nuts on top of the angle bracket. Refer to *Figure 1*. Tighten the first nut against the washer and then tighten the second nut to lock.

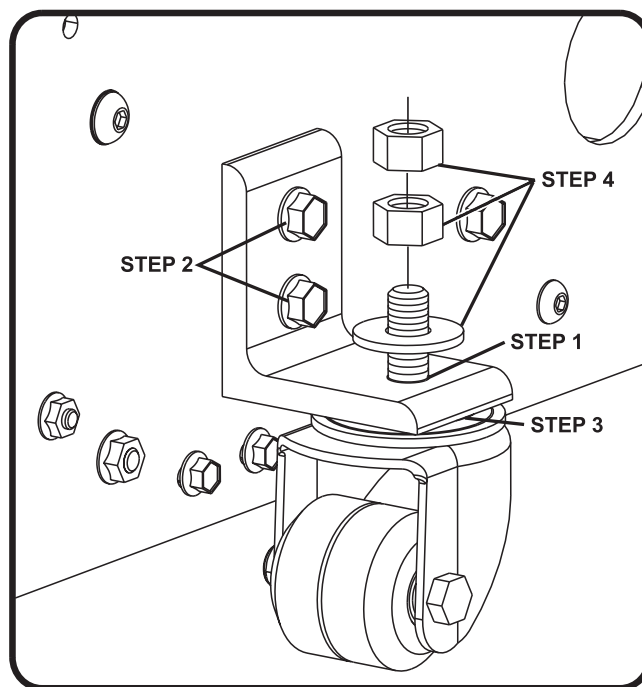

Figure 1