

Adjustable Interlock Linkage

The adjustable interlock linkage makes the relationship between the pin release lever and the interlock fully adjustable. This may be desirable when working with older A/A-2 pinsetters with worn or bent pin release levers.

Packaging

1 ea.	12-862034-000 Package
3 ea.	11-230001-001 X-Washer
1 ea.	11-420046-000 Plain Bearing
2 ea.	11-421045-000 Flanged Bearing
1 ea.	12-150023-008 Pin
1 ea.	12-150158-015 Pin X-Washer
1 ea.	12-150263-000 Assembly - Adjustable Interlock Link
1 ea.	12-900061-000 Instruction Sheet

Tools Required

- Open End Wrench (1/2")
- Open End Wrench (9/16")
- X-Washer Pliers

Installation

1. Remove the two parallel interlock links (12-150237-000) by removing the X-washers (11-230001-001) from the X-washer pins (12-150158-015 and 12-150023-008).
2. Replace the bearing (11-420046-000) in the interlock probe and the 2 flanged bearings (11-421045-000) in the pin release lever with the bearings provided.

3. Position the large yoke of the adjustable interlock linkage over the bushings on the pin release lever and replace the X-washer pin (P/N 12-150158-015) also replace the X-washer . Refer to *Figure 1*.

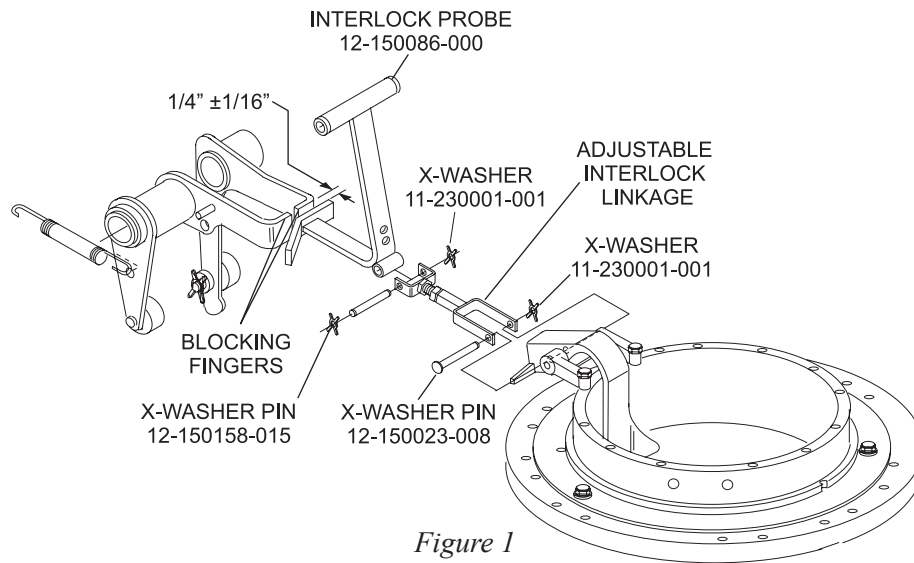

4. Lengthen or shorten the adjustable linkage by unscrewing the small yoke until the gap between the spring urged interlock probe and the blocking fingers is $1/4'' \pm 1/16''$.
5. Replace the X-washer pin (P/N 12-150023-008). Replace the X-washers.
6. Tighten the jam nut to fix the length of the adjustable linkage.