

Adjustable “Y” Switch Bracket

This kit creates adjustment to the internal ball track and “Y” switch, allowing it to line up better with the return track.



NOTE: *Due to the variety of aftermarket switch tracks available, assembly may vary. Some switch track assemblies may need to be brought back to OEM configuration.*

Kit 12-862033-000 Includes:

1	Ea.	12-150021-000	Adjustable “Y” Switch Bracket
2	Ea.	11-002062-001	5/16-18 x 3/4” Hex Head Cap Screw (Grade 5)
2	Ea.	11-170009-001	Nylok Nut

Tools Required

- 6” C-Clamp
- Drill Bit (11/32”)
- Open End Wrench (1/2”)
- Open End Wrench (9/16”)
- Open End Wrench (5/8”)
- 1/2” Socket and Ratchet
- 9/16” Socket and Ratchet
- * Center Punch
- * 1/4” Drill
- * Tap 5/16-18

* *Optional for Quality Bowling switch track with the square rear and closed sides.*

Installation

1. Remove the switch track assembly from the kickbacks, retaining the hardware.
2. Remove and discard the switch stop bracket, 12-502131-000. Refer to *Figure 1*.

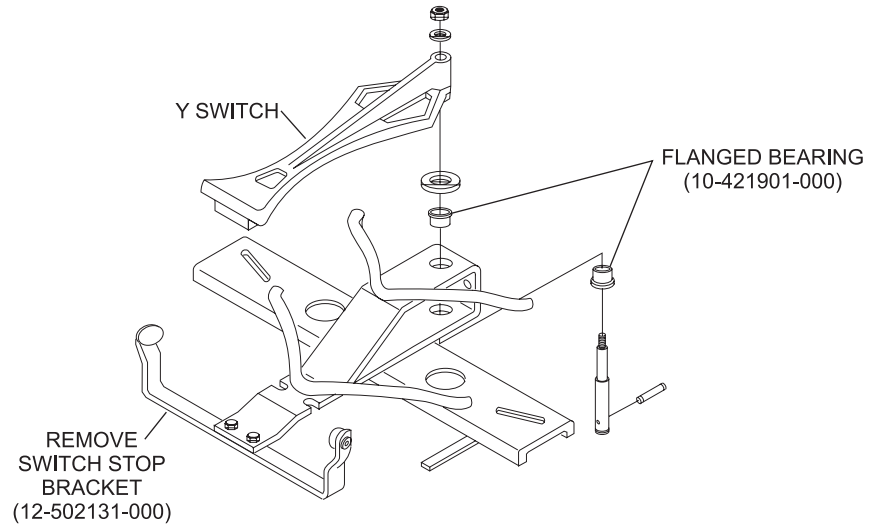

Figure 1

3. Check the flanged bearings, 10-421901-000, for wear and replace as necessary. Refer to *Figure 1*.

- Center the adjustable “Y” switch bracket, 12-150021-000, over the rear of the switch track and clamp it firmly in place with a C-clamp.

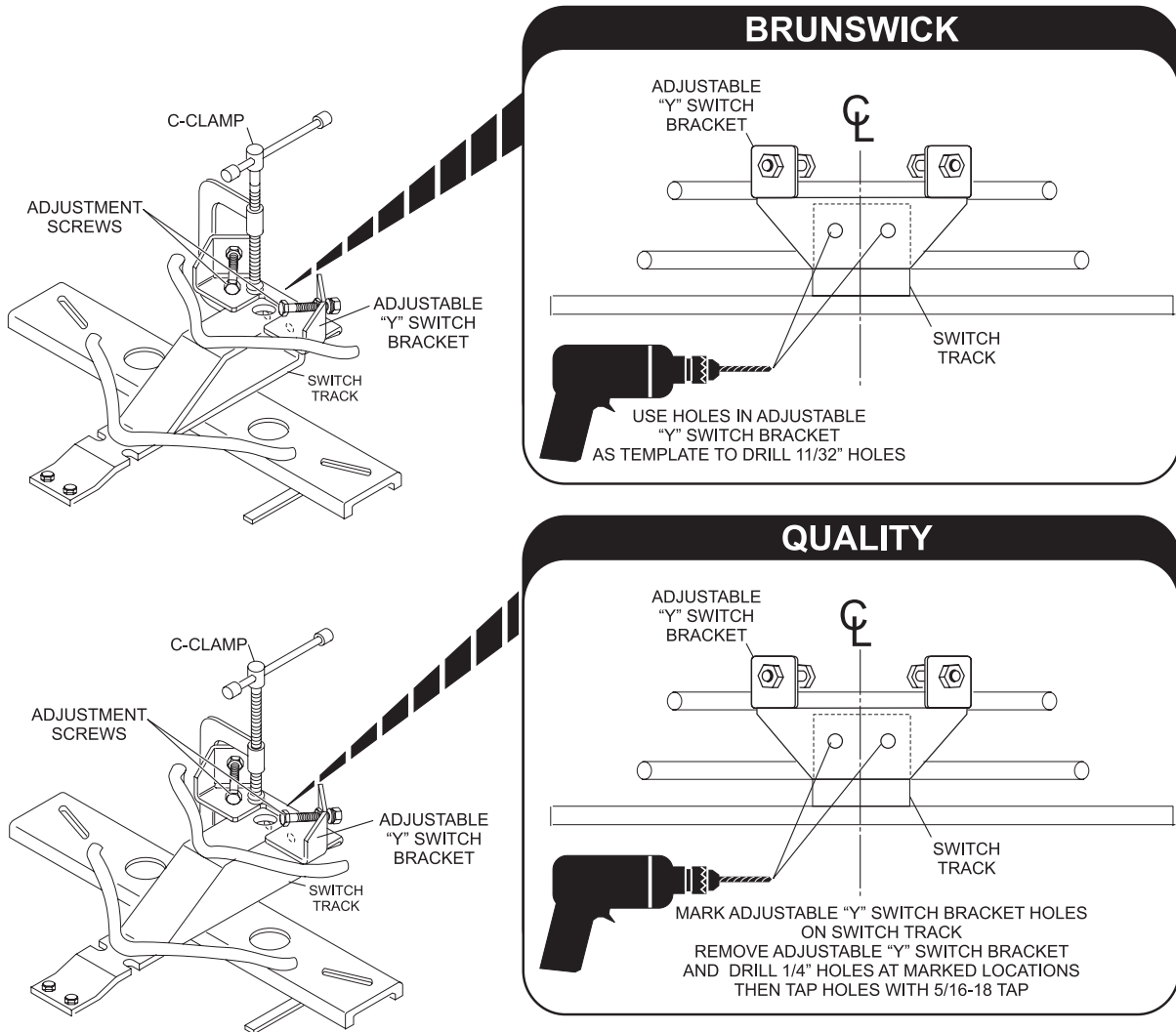

Figure 2

- Using the holes in the adjustable “Y” switch bracket, drill the 11/32” mounting holes. Refer to Figure 2.

i **NOTE:** For Quality bowling switch track, use the holes in the adjustable “Y” switch as a guide and center punch the position of the holes. Then drill 1/4” holes and thread them using the 5/16-18 tap. Use 2 lockwashers, 11-195015-001, (not supplied) when assembling.

- Mount the adjustable “Y” switch bracket onto the switch track using the hardware supplied.

7. Re-assemble the switch track assembly to the kickbacks using the hardware retained in step 1.

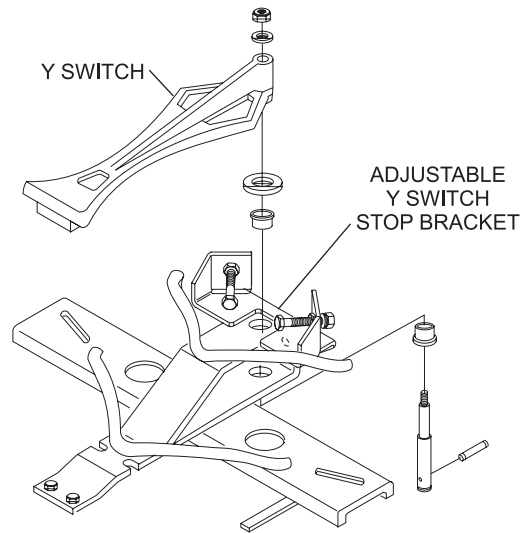

Figure 3

8. Adjust the 3/8" carriage bolts in the adjustable "Y" switch bracket so the "Y" switch transitions the ball from the internal ball track to the return ball track.
9. Tighten the 3/8" jam nuts to secure bolt.