

Ball Accelerator Non Slip Plate

Removal of Existing Plate



WARNING! Remove power from Nexgen controller.

1. Remove ladder from ball box. Refer to *Figure 1*.

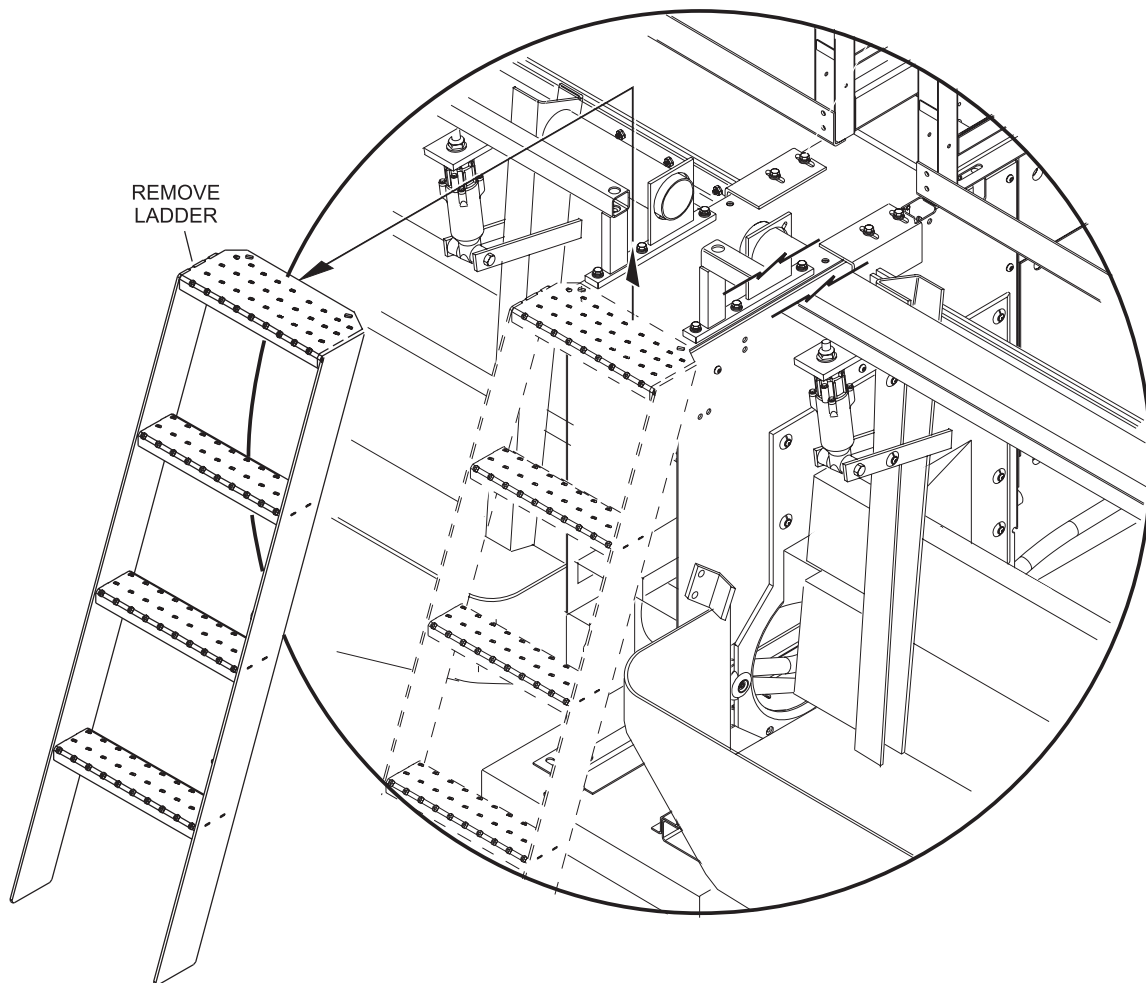

Figure 1

i **NOTE:** Retain all removed hardware for reuse.

2. Remove the six hex head cap screws and locknuts securing the ball cushion assemblies to the ball box. Refer to *Figure 2*.

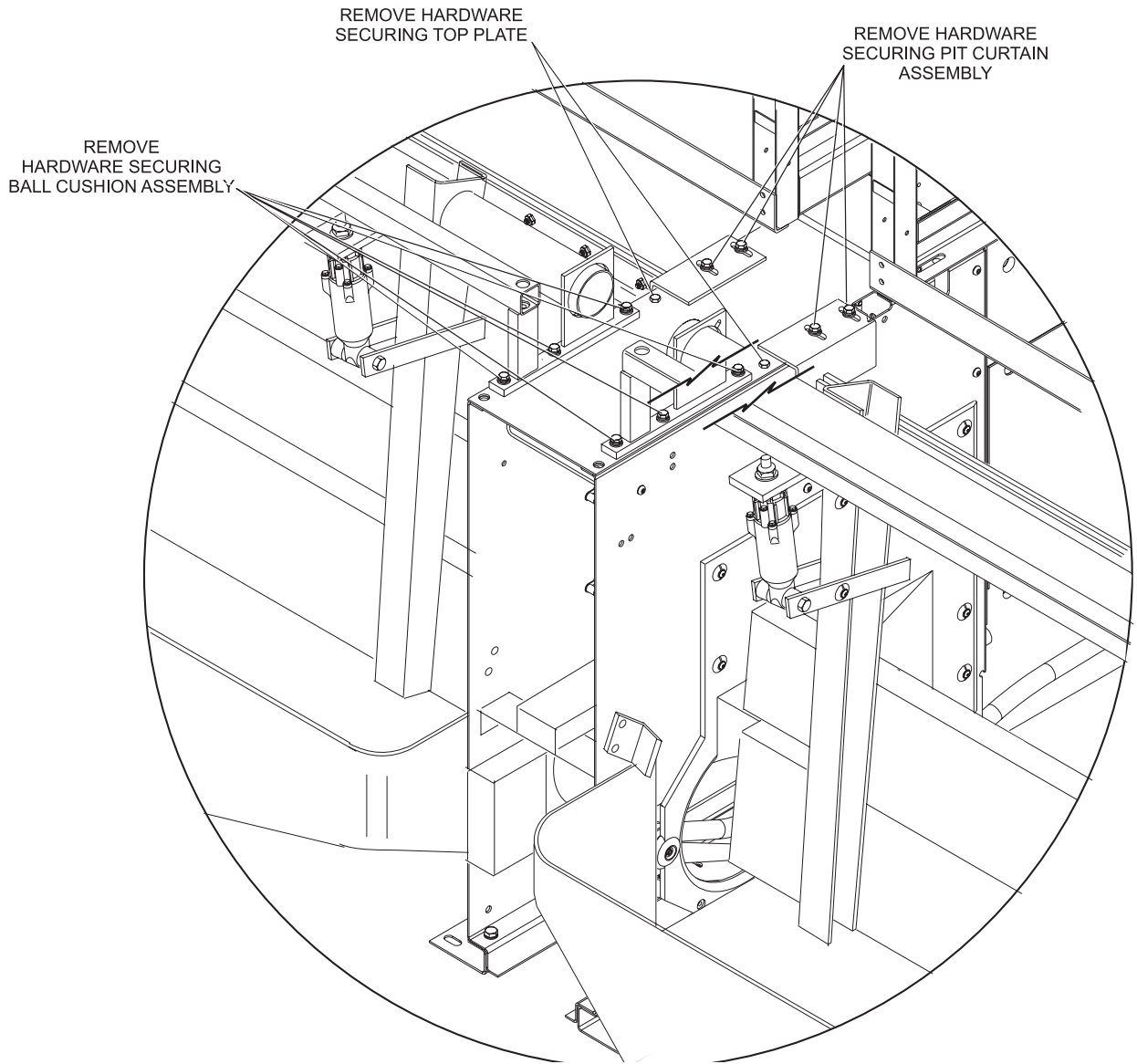

Figure 2

3. Remove the four hex head cap screws, flat washers and locknuts securing the pit curtain assemblies to the ball box. Refer to *Figure 2*.
4. Remove the two hex head cap screws and locknuts securing the top plate to the ball box. Refer to *Figure 2*.

5. Prop up ball cushion assemblies and pit curtain assemblies and remove ball box top plate. Refer to *Figure 3*.

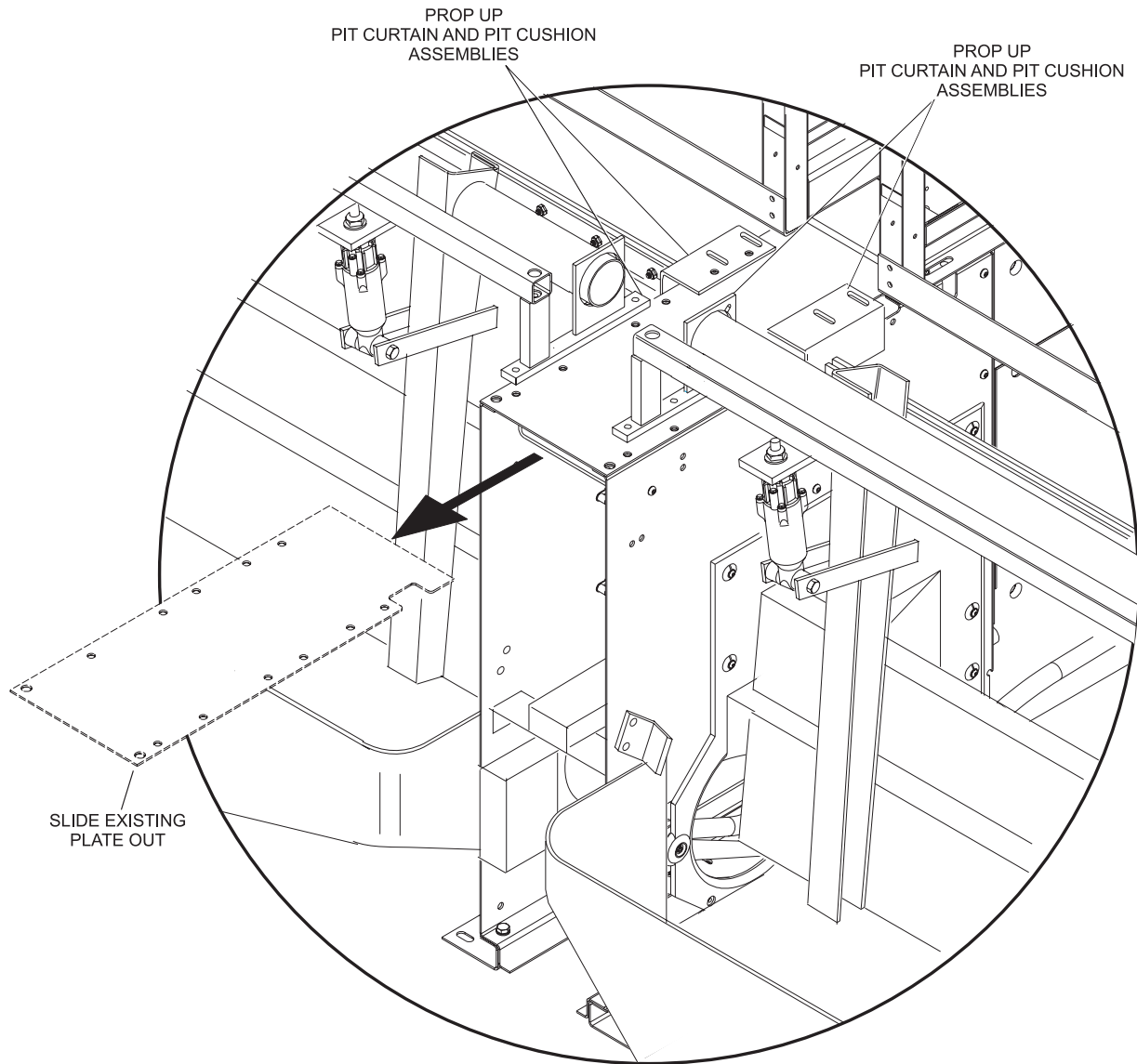

Figure 3

Install New Top Plate

1. Slide new top plate (P/N 47-085971-000) into position. Refer to *Figure 4*.

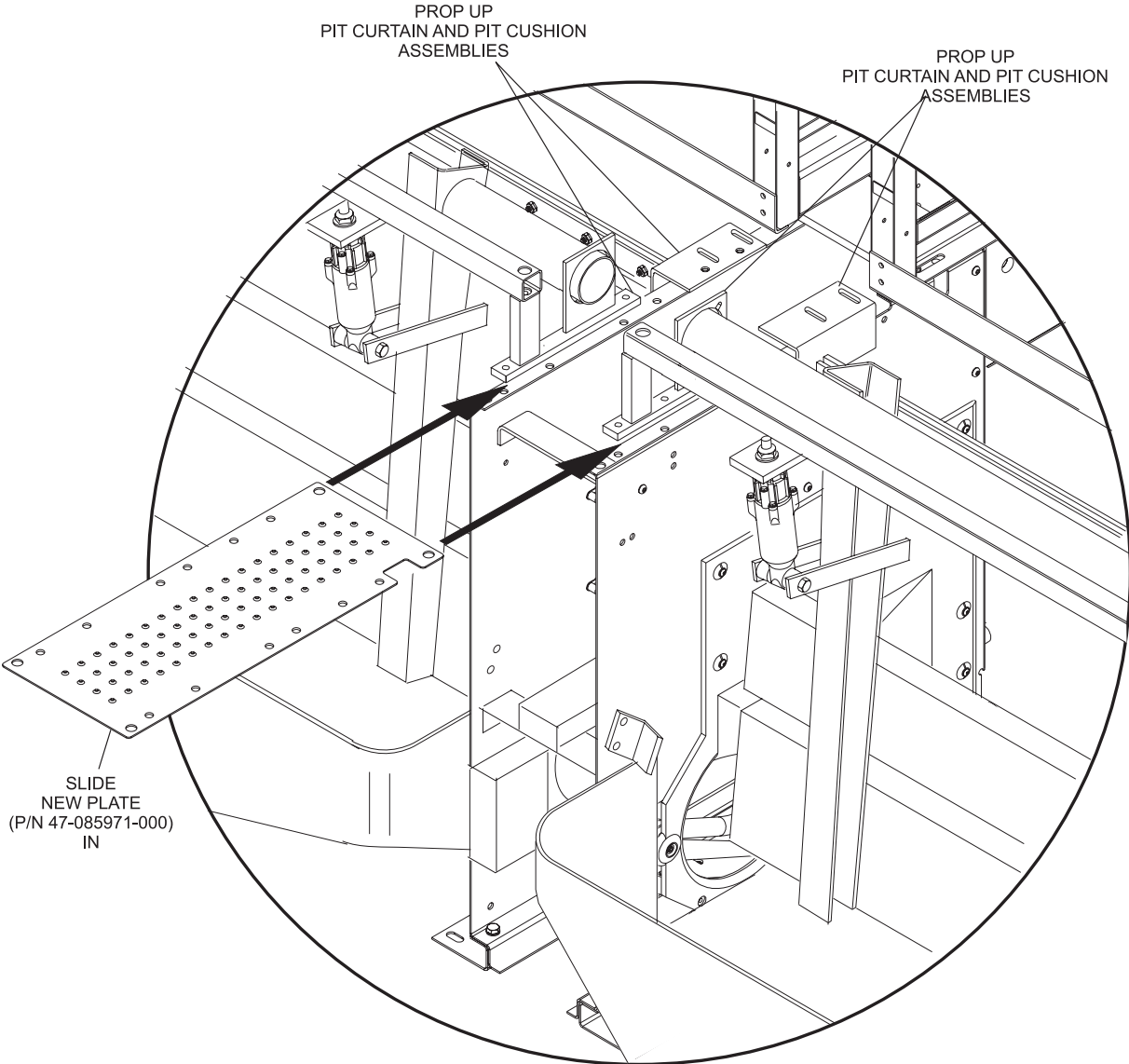

Figure 4

2. Secure new top plate to ball box with existing hardware removed in *steps 1* and *2*. Refer to *Figure 5*.

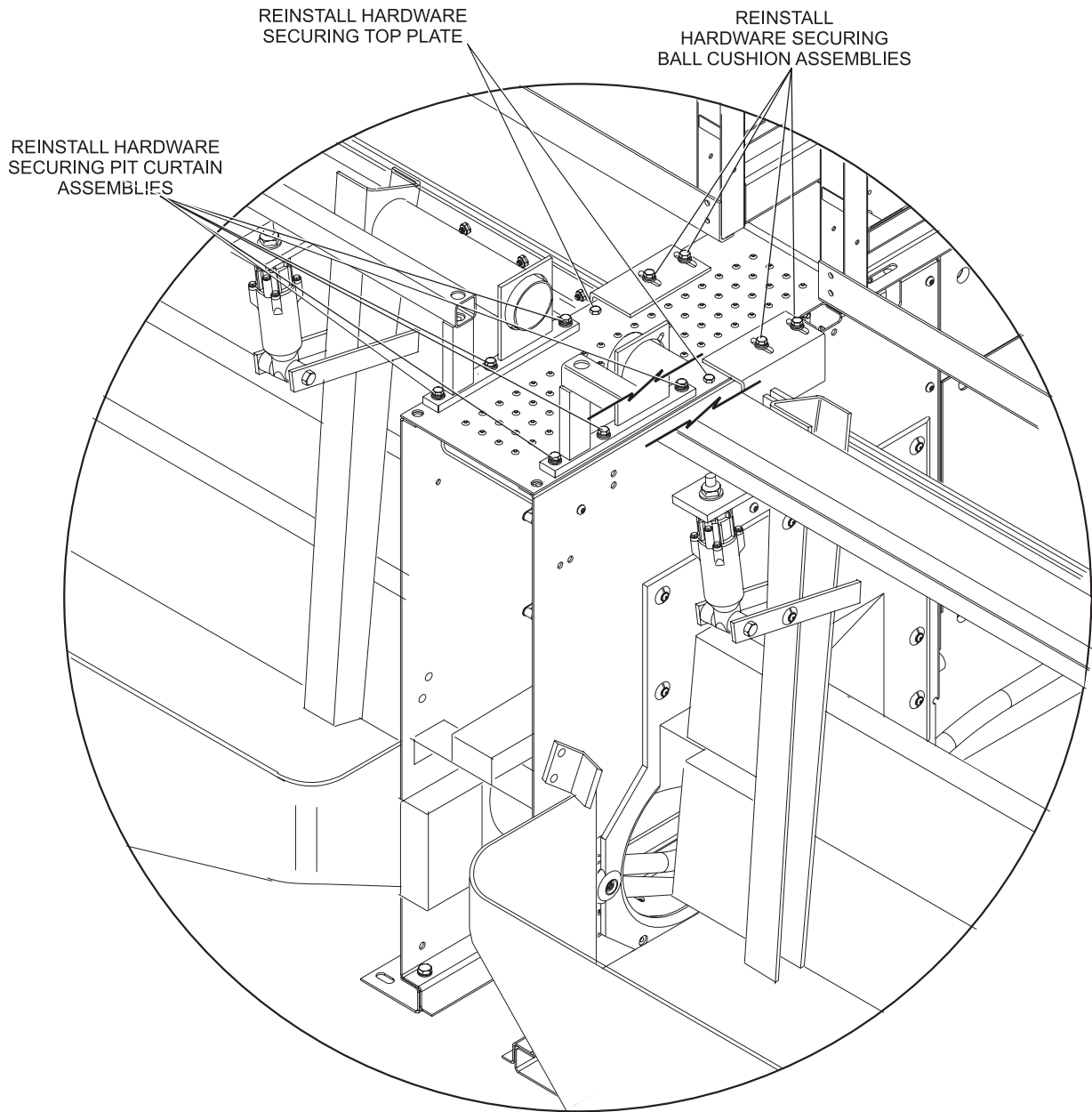

Figure 5