

SERVICE BULLETIN

Subject: Lightworx Cables and Manual Addendums

Date: 10/21/98

Distribution: All Lightworx Customers

Bulletin No. EB98-7

Recently, there have been some issues concerning the wiring of the certain cables and modules used in the Lightworx system. It is **critical** that you check the wiring of the cables and modules as described below. **Failure to verify proper wiring may cause severe damage to Lightworx system.**

Attached, also, are revised cable pages 27 & 28 of the 84-900027-000, Lightworx Installation Manual and new service parts pages, 24Q – 27Q, which will be incorporated into the 28-201739-000, Bowling Service Parts Catalog. These pages provide additional cabling and system details. Please update your publications with these new pages.

35” Light Module To Light Module Cable (84-200287-000) and 20’ Address Decoder Module to Light Module Cable (84-200298-000)

These cables connect between the Address Decoder Module and Light Module and Light module to Light Module. They are wire colored and pinned the same and vary only in length. In some instances, wires 2 and 3 at one end of the cable are switched in the connector housing. It is **critical** that you check these cables to verify that they are wired the same at both ends **before** connecting it to the system. Cables must be wired as shown in Figure 1.

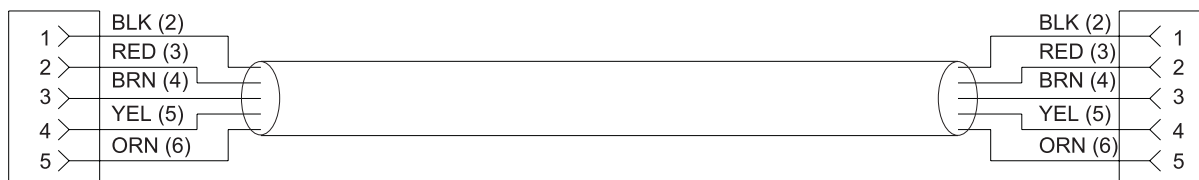

Light Module to Light Module Cable, 84-900287-000 - 35 inches long
Address Decoder Module to Light Module Cable, 84-900298-000 – 20 feet long

Figure 1

Control Module Interface Cable (84-200289-000)

This cable connects the Address Decoder Modules to the Lightworx Controller. On a few cables, the 15-pin connector at the Lightworx Controller end was mistakenly placed in a cover typically used for 25-pin connectors. As a result, the connector cannot be securely attached to the Controller unit and may eventually fall off. See Figure 2. To obtain the proper cover (Part Number 11-680998-000) or a replacement cable, contact the Brunswick Response Center 1-800-323-8141.

Light Module Connections

The Light Modules are designed with specific In and Out connectors. It is *critical* that the cable routed from the Address Decoder Module plug into the input connection at the Light Module. *Plugging the cable into the output connection will cause severe damage to Lightworx system.* See Figure 2.

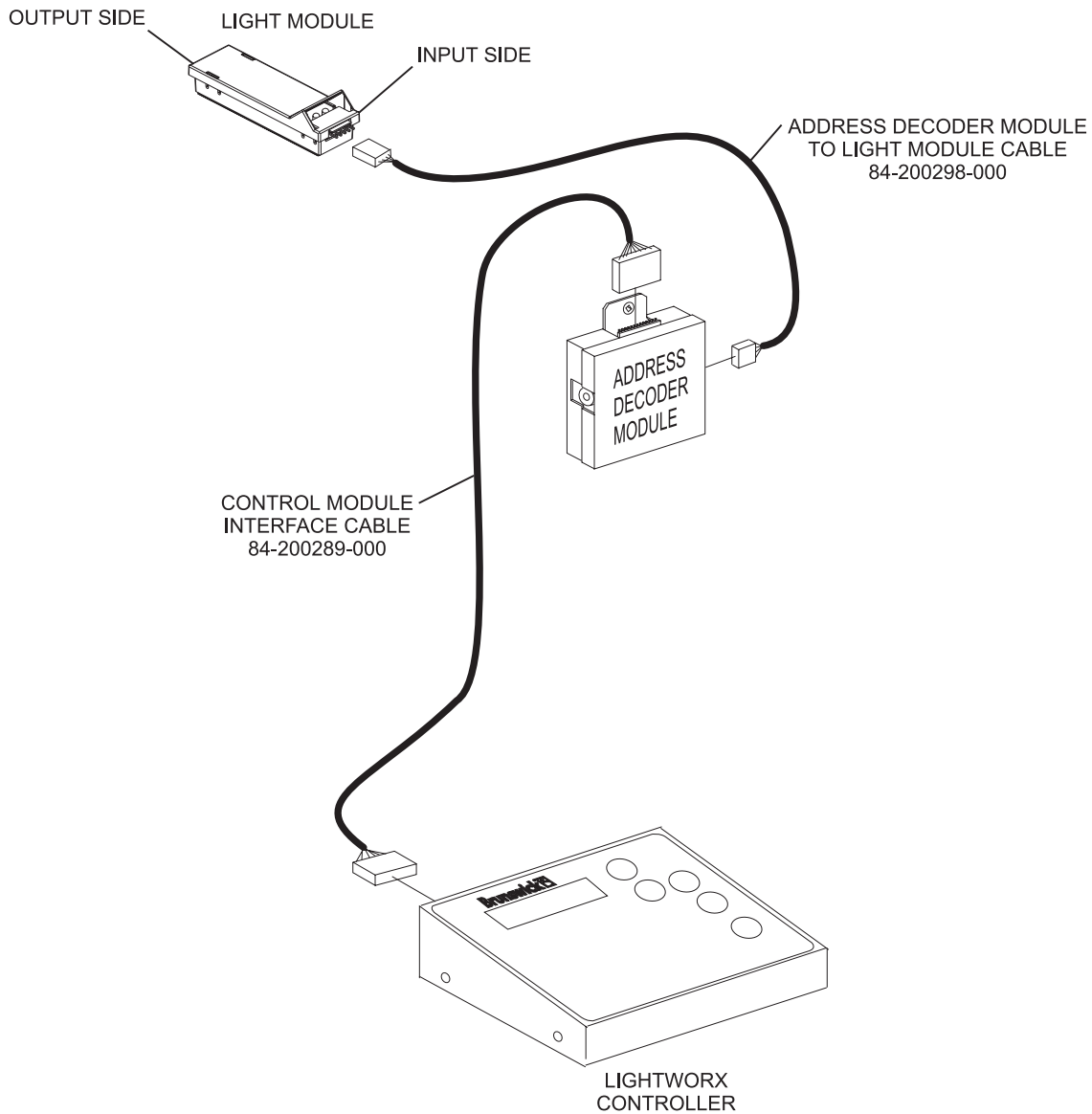

Figure 2

Address Decoder Connections

Most installations require a terminator plug at the last Address Decoder Module. In some situations this terminator may cause interference with Light Module operation. If this occurs, remove the terminator and check the system operation again. See Figure 3.

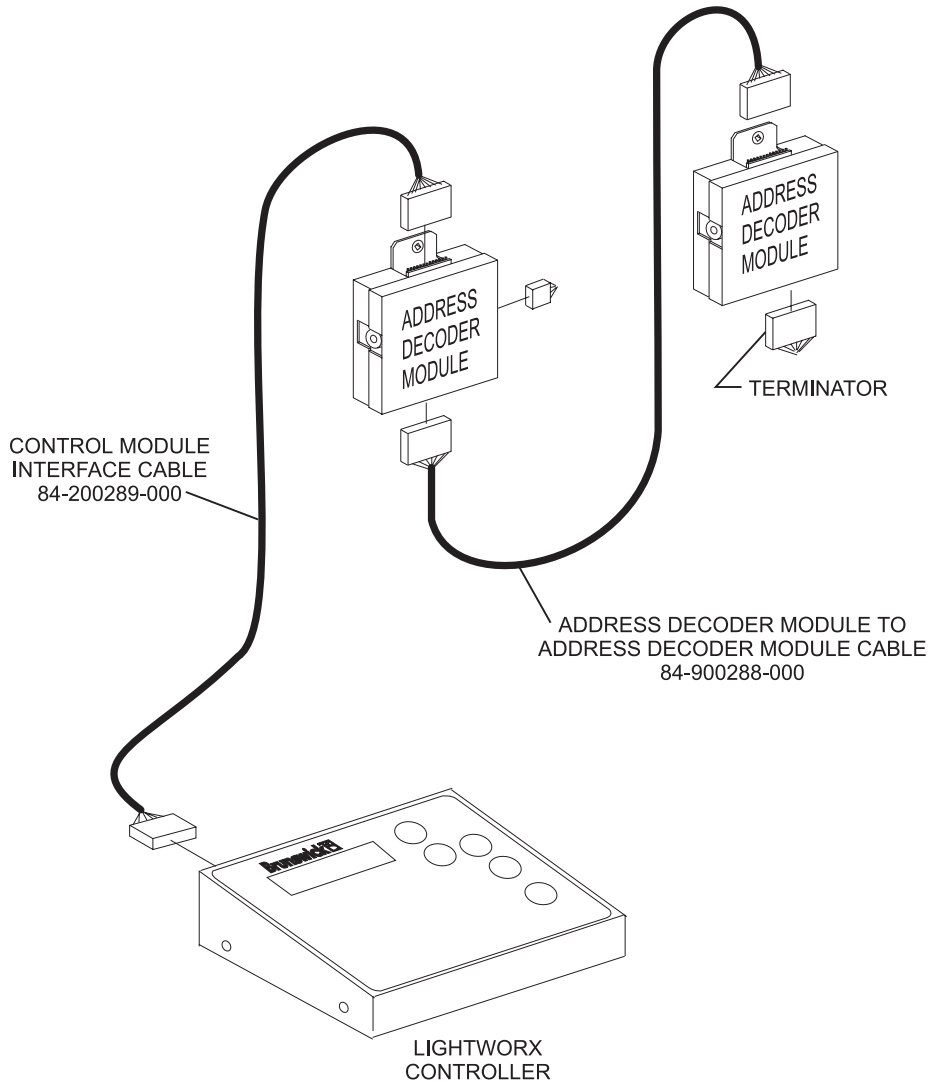



Figure 3

If there are any questions concerning these procedures, please contact the Brunswick Response Center 1-800-323-8141.

William P. Jager
Service Product Engineer

David E. Rice
Director of Service and Installation