

SERVICE BULLETIN

Subject: Frameworkx Tel-E-Foul Cover Lens Improvement

Date: 4/12/10

Bulletin No. SB10-4

We are pleased to announce the release of a more robust mounting system for the Frameworkx Tel-E-Foul cover, red lens. The enhanced design secures the lens to the support boss for the foul light cover with a button head screw. Refer to *Figure 1*.

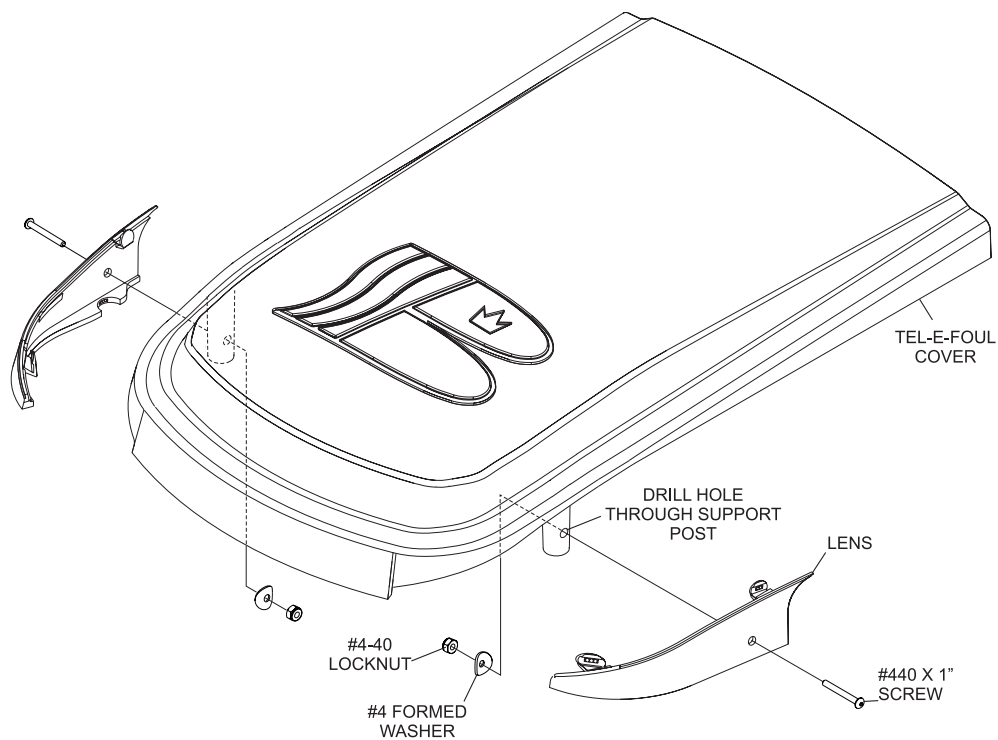



Figure 1

This design change will be implemented in all new production going forward. The cover assembly has a new part number, 84-860769-000. This replaces the old part number, 84-860603-000.

This is also available in a kit from service parts. The Brunswick Tel-E-Foul Lens Replacement Kit, part number 84-860770-000, is currently available and includes all the components to replace the lenses on one cover. Those components are:

Qty.	Part Number	Description
1 ea.	84-200249-001	R.H. Return Tel-E-Foul Cover Lens
1 ea.	84-200249-002	L.H. Return Tel-E-Foul Cover Lens
2 ea.	11-006010-000	#4-40 x 1" Button Head Cap Screw
2 ea.	10-195001-000	#4 Washer
2 ea.	11-170000-001	#4-40 Self Locking Nut
1 ea.	84-900214-000	Instruction Sheet

If you have questions regarding the information contained in this Service Bulletin, please contact Brunswick Technical Support at 1-800-937-2695 or 231-725-4966, FAX 231-725-4667, or Email techsupport@brunbowl.com Visit <http://www.brunswickbowling.com/service-support/tech-support/> for electronic files of this and other Service Bulletins.



David J. DiRito
Installation Training & Certification Manager



David E. Rice
Director of World Wide Service