

# Information Sheet

## Jade Tour Quantum

### Specifications

Axiom Proactive Urethane Cover Stock  
Polished finish  
Hook Potential: 19 (dull/shiny)  
Typical Length: 2  
Typical Backend: 11  
Average RG: 4.2  
Track Flare Potential: 4.3



### Reaction Characteristics

Jade Tour Quantum, the latest and greatest achievement in Quantum's history. Once again BTV's engineers have revolutionized bowling and completely changed the way bowling balls will be expected to perform forever!

Axiom is not a reactive urethane, it is proactive urethane! Proactive technology has created a surface that gives better contact with the lane in the presence of oil. The lane-hugging traction generated by Axiom inspires confidence in the strength of the reaction and the repeatability. It not only adjusts to each condition, it enhances each bowler's individual strengths. Axiom merely takes the game and puts the control back into the hands of the bowlers.

The Jade Tour Quantum combines a medium strength Proactive coverstock with a low flare core to produce a ball that delivers the traction effect of Proactive urethane at a hook potential similar to current strong reactive urethane balls.

Jade Tour gives bowlers a tamer version of the original that is harder through the break point, more forgiving, and more controllable than current reactive technology.

### Drilling Information

All weights of the **Jade Tour Quantum** can be drilled using the techniques developed for two-piece balls. See Brunswick's "Seven Popular Layouts" and the following page for detailed drilling information.



# Information Sheet

## Jade Tour Quantum

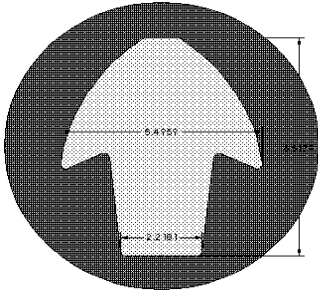

16 POUNDS

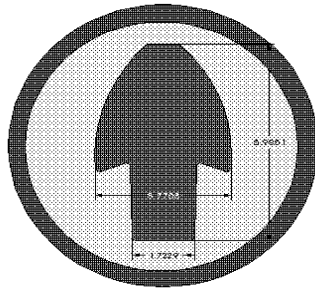

15 POUNDS

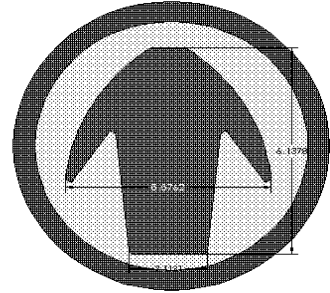

14 POUNDS

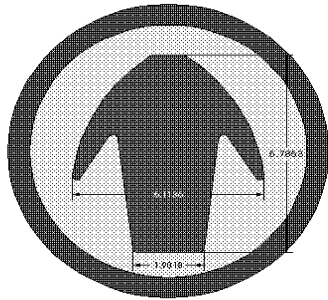

13 POUNDS

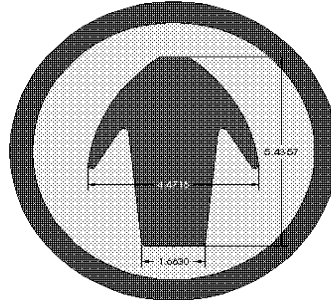

12 POUNDS

The revolutionary performance characteristics of Axiom Proactive Urethane allow the bowler to more fully utilize layout choices to create desired reactions. Because of the new material, stronger release players would be advised to stay with layouts 4-7 on the seven popular layout sheet. For the more average bowler that wants a ball reaction more like a cranker, layouts 1-3 will produce very strong reactions.

